

FORM NO 1.

York County shore

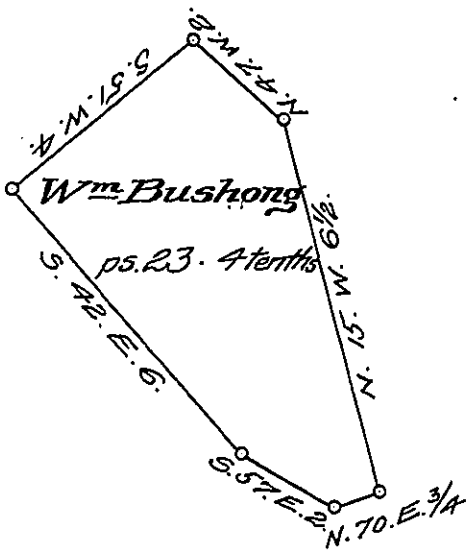

Lancaster County Shore

A Draught of Duke Island situate in the River Susquehanna in Conestogoe township Lancaster County opposite to land of Conrad Heble on the Lancaster shore and opposite the Mullet Seine on the West side just below Jerrys Falls & below Little Beaver Island Containing twenty three perches and four tenths Strict Measure surveyed in pursuance of a Warrant dated 24<sup>th</sup> day of October A.D. 1816 granted to William Bushong.

p<sup>c</sup> Jacob Hibshman D.S.

To Jacob Spangler Esq<sup>r</sup>  
Surveyor General.

IN TESTIMONY that the above is a copy of the original remaining on file in the Department of Internal Affairs of Pennsylvania, made conformably to an Act of Assembly approved the 16th day of February, 1833, I have hereunto set my Hand and caused the Seal of said Department to be affixed at Harrisburg, this twenty sixth day of November 1907.

Henry Howek  
Secretary of Internal Affairs.